

# PROPOSITIONS D'INSTALLATION

Accessoires nécessaires :

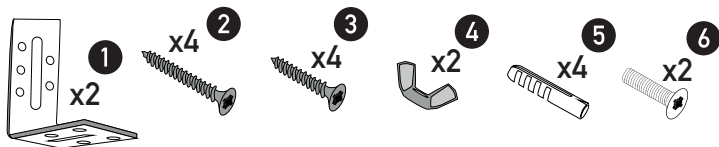

Matériels nécessaires :

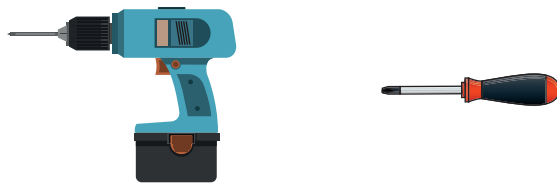

## FIXATION HAUTE

ÉTAPE 1



ÉTAPE 2

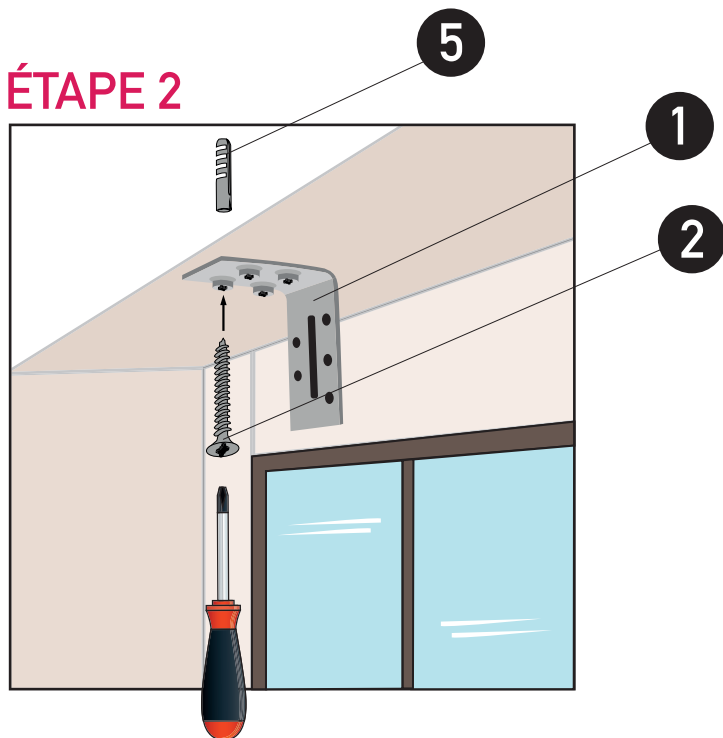

ÉTAPE 3

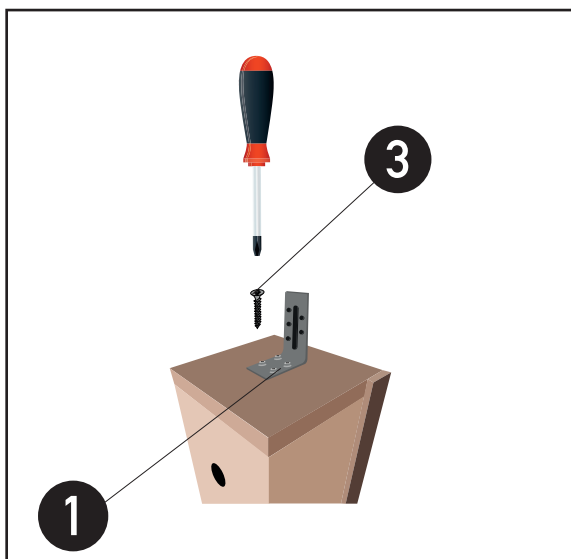

ÉTAPE 4

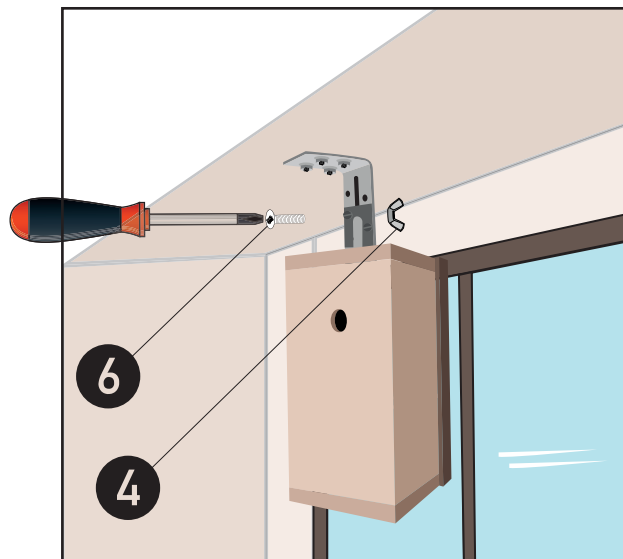

VÉRIFIER LA BONNE OUVERTURE DES TRAPPES

## FIXATIONS LATÉRALES (VARIANTES)

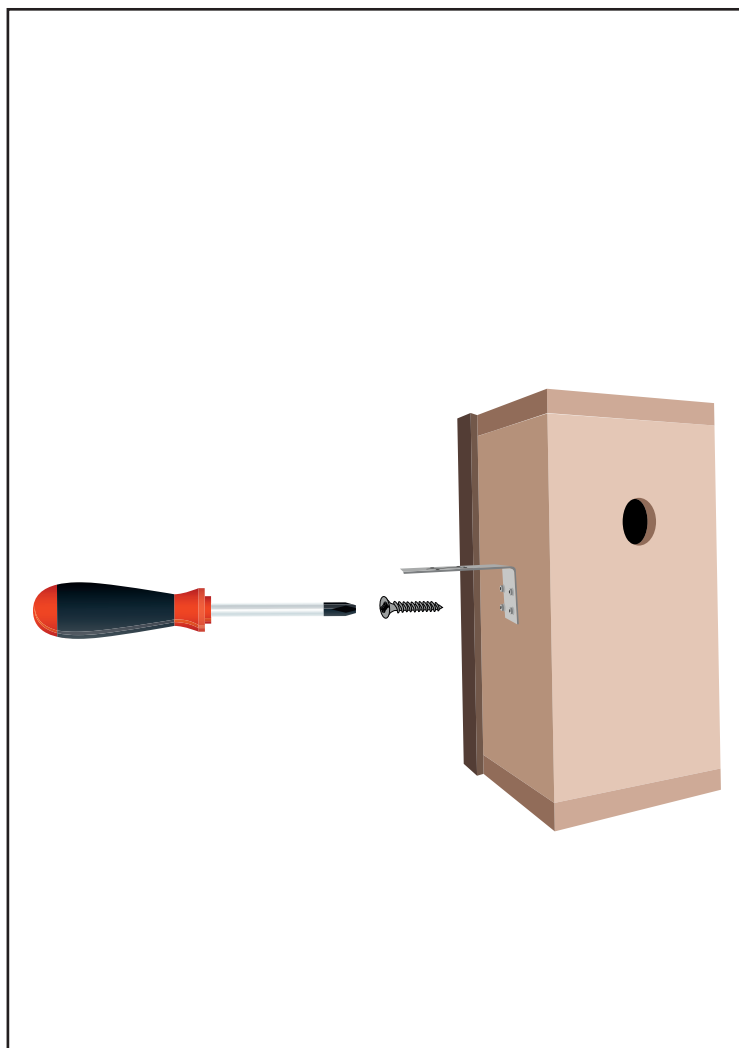
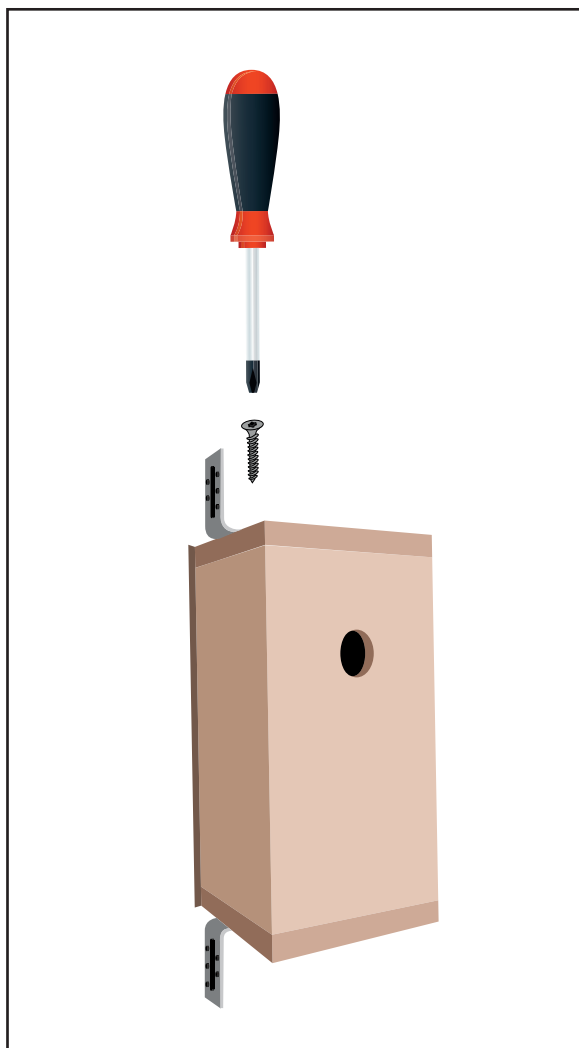

## INSTALLATION DE LA MANGEOIRE

